

# Building Directory

1895 Field Duplex	F4	Henry Hall	D2
1976 Hall	F4	Henry House	E1
Aaron Burr Hall	F1	Hibben Magee Road, 201-215	E7
Alexander Street, 228	D4	Hibben Magee Road, 401-413	E7
Alexander Street, 262	D6	Hibben Magee Road, 502-510	E7
Alexander Street, 262A	D6	Hibben Magee Road, 600	E8
Alexander Street, 272	D6	Hibben Magee Road, 703-724	E8
Alexander Street, 282	D7	Hibben Magee Road, 751	E7
Alexander Street, 294	D7	Holder Hall	G1
Alexander Street, 306	D7	Hoy Chemical Laboratory	G1
Alexander Street, 350	D8	Ivy Lane 5	D3
Alexander Street, 378	D8	Jadwin Gymnasium	H5
Alexander Street, 81	C3	Jadwin Hall	G4
Alexander Street, 99	C2	Joline Hall	F1
Audinger Center	F2	Julius Roma Rabinowitz Building	F1
Architectural Laboratory	G5	Lakeside Road, 102-128	E7
Architectural Building	F2	Lakeside Road, 130	D7
Art Museum	E2	Lakeside Road, 200	E7
Arts Tower	D4	Lakeside Road, 202-210	D7
Baker Hall 'B'	D4	Launch House	F7
Baker Hall 'S'	D4	Launch House	D3
Baker Rink	D4	Lenox Court, 301-315	E7
Bendheim Center For Finance	G2	Lenox Court, 351	E7
Bendheim Hall	G2	Lewis Library	D3
Berlin Theater	D2	Lewis Hall	D3
Bhair Hall	D3	Lockhart Hall	G2
Bloomberg Hall	E4	Louis A. Simpson International Building	F1
Boggs Hall	E4	Louis - Love Pavilion	A1
Bowen Hall	H2	Lowry House	F1
Broadmead Swim Club	H2	Maclean House	E1
Broadmead, 171	J3	MacMillan Annex	E4
Broadmead, 185	J3	MacMillan Building	E1
Brown Hall	E2	Madison Hall	D1
Burns Building	H10	Macler Hall	H2
Buysen Hall	D9	Mars Hall	F2
Caldwell Field House	H14	Mars Theater	D3
Campbell Hall	D3	McCormick Hall	E2
Campus Club	D3	McCosh Hall	F3
Cargot Brasserie	D3	McCosh Hallway	G1
Carl C. Icahn Laboratory	F4	McDonnell Hall	G3
Center for Jewish Life	G3	Moffet Laboratory	F3
Chambers Street, 22	D8	Morrison Hall	E3
Chambers Street, 34	D0	Murphy-Pivovito Family Tower	D3
Chancellor Green	E1	Murray Theatre	E1
Chapel	F1	Nassau Hall	E1
Charles Street Substation	H1	Nassau Street, 112	B0
Charter Club	E0	Nassau Street, 114	E0
Child Care Center	J3	Nassau Street, 116-122	F0
Child Water Fountain	E5	Nassau Street, 158	F0
Clarke Field Duplex	I3	Nassau Street, 160	F0
Clarke Field Press Box	I2	Nassau Street, 163	F1
Class of 1879 Hall	F3	Nassau Street, 169	F0
Class of 1917 Hall	F3	Nassau Street, 173	F0
Class of 1903 Hall	E3	Nassau Street, 175	F0
Class of 1915 Hall	E3	Nassau Street, 179 & 183	F1
Class of 1927-Clapp Hall	F3	Nassau Street, 185	F0
Class of 1937 Hall	F3	Nassau Street, 194	G0
Class of 1938 Hall	F3	Nassau Street, 199	G0
Class of 1939 Hall	E4	Nassau Street, 201	G1
Class of 1952 Stadium	E4	Nassau Street, 221	H0
Class of 1967 Hall	E4	Nassau Street, 24	C0
Class of 1981 Hall	E4	Nassau Swim Club	B0
Clio Hall	E1	New Music Building	D4
Cogeneration Plant	D5	New South Building	D5
College Road West, 26	B3	North Garage	H2
Community Hall	E3	North Guard Gate	D1
Computer Science Building	G2	Nursery Office	L8
Cordell Family Pavilion	E5	Nursery	L8
Cowley Hall	H1	Palmer House	C0
Courtyard Annex	G10	Patton Hall	E3
Cuyler Hall	E2	Penniman Scully Hall	E3
Davis Building	H5	Peyton Hall	G3
DeNunzio Pool	H1	Princeton Neuroscience Institute	F4
Dickinson Hall	D4	Princeton Stadium	D4
Dickinson Street, 2	D2	Princeton Station	D4
Dillon Court East	E3	Prospect Avenue, 115	I2
Dillon Court West	D3	Prospect Avenue, 21	G2
Dillon Gymnasium	E2	Prospect Avenue, 58	I2
Dodge-Bar and Kitchen	D2	Prospect Avenue, 87	I2
Dod Hall	E1	Prospect Avenue, 91	E1
Dodge-Dobson Hall	F3	Prospect House	D2
East Pyne Building	E1	Pyne Hall	F2
Edwards Hall	E2	Roberts Stadium West Pavilion	F5
Elementary Particles Lab East	E2	Robertson Hall	F2
Elementary Particles Lab West	E2	Rock Magnetism Laboratory	F3
Elm Drive Substation	D5	Schedule Caldwell House	F1
Elm Drive, 200	E4	Schultz Laboratory	F3
Engineering Quad A-Wing	H1	Scully Hall	F4
Engineering Quad B-Wing	H1	Shea Rowing Center	E6
Engineering Quad C-Wing	H1	South Guard Gate	G1
Engineering Quad D-Wing	H1	Spelman Halls	D8
Engineering Quad E-Wing	H1	Spens Pavilion	F4
Engineering Quad F-Wing	H1	Springdale Clubhouse	B3
Engineering Quad G-Wing	H1	Stanhope Hall	D3
Engineering Quad J-Wing	H1	Taylor Court, 101-111	E1
Finch Hall	F3	Taylor Court, 151	E7
Faculty Road, 125-137	D6	Tennis Pavilion	F5
Feinberg Hall	E3	Terrace Club	G2
Fine Hall	G2	Thomas Laboratory	F1
Frostee Library	E1	University Place, 11	C1
Fisher Hall	G3	University Place, 23	C1
Fisher Hall Dorm	E3	University Place, 27	C1
Fritz-Randolph Observatory	E4	University Place, 36	D1
Forbes College Main	C4	University Place, 39	D2
Foulke Hall	D2	University Place, 48	D2
Frick Chemistry Laboratory	G2	University Place, 71	D2
Friend Center	G1	Von Neumann Hall	H
Frist Campus Center	F2	Walker Hall	E3
Gauss Hall	E3	Wallace Dance Building and Theater	D4
GHM Office Trailer	E6	Wallace Hall	G1
Graduate College, New	D4	Wares	D4
Graduate College, Old	A4	Wendell Hall 'B'	D3
Green Hall	E6	Wendell Hall 'C'	D3
Grinder Lab	F3	West Garage	D3
Grounds Storage Building	E6	Whig Hall	E1
Grounds Storage Shed #1	E6	Wilcox Hall	E3
Grounds Storage Shed #2	E6	Wolf Hall	F4
Gulick Pavilion	E5	William Street, 41	G1
Guyot Hall	F3	Witherspoon Hall	D1
Haggis House	I8	Woolworth Music Center	F2
Hamilton Hall	D1	Wyeth Hall	E3
Hargaden Hall	D3	Wy Hall	E3
Helm Building	D7	Yocoff Hall	E3

**PRINCETON UNIVERSITY**

**Accessible/ Inaccessible Buildings**

- Building Accessible on ALL Levels
- Building Accessible on one level or more
- Building Inaccessible
- Accessible entrance
- Accessible Route
- Off Campus or Non-University Building
- Building Under Construction - Fenced
- Small Vehicle Crossing
- 23 Parking Lot Number
- P Accessible Parking

Dec. 12, 2017

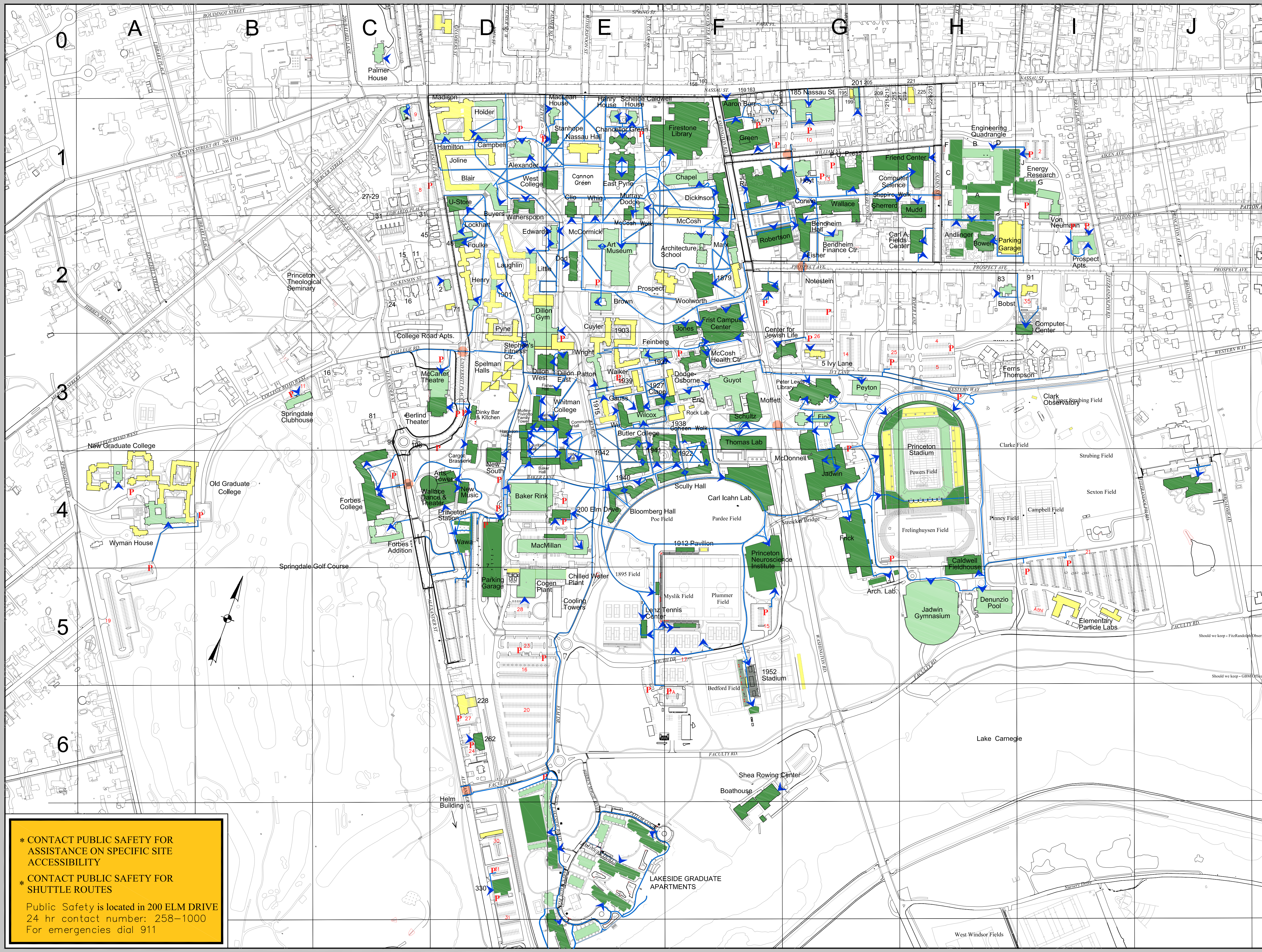

**\* CONTACT PUBLIC SAFETY FOR ASSISTANCE ON SPECIFIC SITE ACCESSIBILITY**

**\* CONTACT PUBLIC SAFETY FOR SHUTTLE ROUTES**

Public Safety is located in 200 ELM DRIVE  
24 hr contact number: 258-1000  
For emergencies dial 911